

# Arruelas lisas Tipo Stanley QX-991

Tabela 91

Arruela Lisa - Tipo Stanley

QX - 991

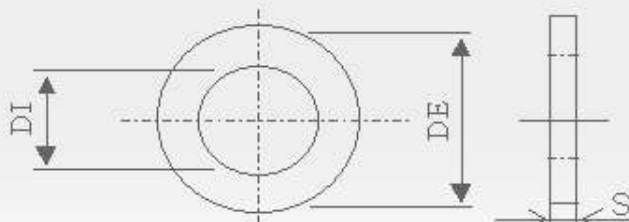

Código S1	Diam. Nominal	Diam. Int.		Espessura	PESO VILH.	QUANT. KILO	DIMENSÕES
		di	de				
910018	1/8	3,3	8,3	0,8	0,29	3.452	8,3x3,3x0,8
910532	5/32	4,3	11,0	1,2	0,77	1.302	11x4,3x1,2
910316	3/16	5,0	12,0	1,2	0,89	1.122	12x5,0x1,2
910732	7/32	6,0	13,6	1,2	1,12	896	13,6x6x1,2
910014	1/4	7,0	14,0	1,2	1,10	908	14x7,0x1,2
910516	5/16	8,4	18,0	1,2	1,90	527	18x8,4x1,2
910038	3/8	10,0	22,0	2,0	4,79	209	22x10x2,0
910716	7/16	12,0	24,0	2,0	5,39	185	24x12x2,0
910012	1/2	13,5	28,0	2,5	9,39	106	28x13,5x2,5
910916	9/16	15,0	30,0	2,5	10,54	95	30x15x2,5
910058	5/8	17,0	34,0	2,5	13,53	74	34x17x2,5
910034	3/4	20,0	40,0	3,0	22,47	44	40x20x3,0

Código S1	Diam. Nominal	Diam. Int.		Espessura	PESO VILH.	QUANT. KILO	DIMENSÕES
		di	de				
912516	5/16	8,4	16,0	1,6	1,83	546	16x8,4x1,6
912038	3/8	10,5	19,0	2,0	3,09	323	19x10,5x2,0
912716	7/16	12,0	22,0	2,0	4,19	238	22x12x2,0
912012	1/2	13,5	25,0	2,0	5,46	183	25x13,5x2,0
912058	5/8	17,0	32,0	2,7	12,24	81	32x17x2,7
912034	3/4	21,0	34,0	3,0	13,23	75	34x21x3,0