

# Arruela Lisa Qx – 126

Tabela 26

Arruela Lisa

QX - 126

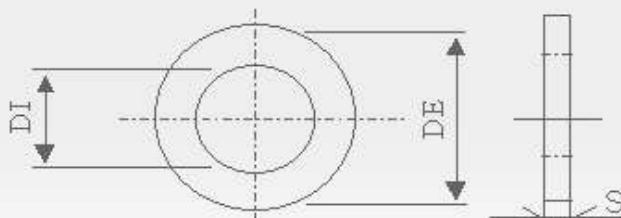

Codigo 26	M/ Parafusos	Dim. Int.		Dim. Ext.	Espessura	Peso MLR.	QUANT. MLD	DIMENSÕES
		DI	DE					
260500	M-5	5,5	5,8	10,0	1,0	0,43	2.326	10x5,5x1,0
260600	M-6	6,6	6,96	12,0	1,6	1,11	901	12,5x7x1,6
260700	M-7	7,6	7,96	14,0	1,6	1,36	735	14x7,6x1,6
260800	M-8	9,0	9,36	16,0	1,6	1,72	581	16x9,0x1,6
260010	M-10	11,0	11,43	15,0	2,0	2,36	423	19x11x2,0
260012	M-12	13,5	13,93	24,0	2,5	5,85	171	24x14x2,5
260014	M-14	15,5	15,93	28,0	2,5	8,13	123	28x16x2,5
260016	M-16	17,5	17,93	30,0	3,0	10,60	94	30x18x3,0
260018	M-18	20,0	20,52	34,0	3,0	14,00	71	34x20x3,0
260020	M-20	22,0	22,52	37,0	3,0	16,40	61	37x22x3,0
260022	M-22	24,0	24,52	39,0	3,0	17,50	57	39x24x3,0
260024	M-24	26,0	26,52	44,0	4,0	31,10	32	44x26x4,0
260027	M-27	30,0	-	50,0	4,0	39,40	25	50x30x4,0
260030	M-30	33,0	-	56,0	4,0	50,50	20	56x33x4,0
260033	M-33	36,0	-	60,0	5,0	71,00	14	60x36x5,0
260036	M-36	39,0	-	66,0	5,0	87,30	11	66x39x5,0
260039	M-39	42,0	-	72,0	6,0	126,00	7,54	72x42x6,0
260042	M-42	45,0	-	78,0	7,0	175,00	5,71	78x45x7,0
260045	M-45	48,0	-	85,00	7,0	212,0	4,72	85x48x7,0
260048	M-48	52,0	-	92,0	8,0	284,00	3,52	92x52x8,0
260052	M-52	56,0	-	98,0	8,0	315,00	3,13	98x56x8,0
260056	M-56	61,0	62,0	105,0	9,0	398,00	2,51	105x62x9,0
260060	M-60	65,0	66,0	110,0	9,0	430,00	2,33	110x66x9,0
260064	M-64	70,0	-	115,0	9,0	462,00	2,16	115x70x9,0
260072	M-72	78,0	-	125,0	10,0	588,00	1,70	125x78x10,0
260080	M-80	86,0	-	140,0	12,0	914,27	1,09	140x86x12,0
260090	M-90	96,0	-	160,0	12,0	1.227,42	0,81	160x96x12,0
260100	M-100	107,0	-	175,0	14,0	1.676,02	0,60	175x107x14,0
260110	M-110	117,0	-	185,0	14,0	1.794,88	0,56	185x117x14,0
260120	M-120	127,0	-	210,0	16,0	2.793,97	0,36	210x127x16,0
260125	M-125	132,0	-	220,0	16,0	3.094,13	0,32	220x132x16,0
260130	M-130	137,0	-	220,0	16,0	2.955,78	0,34	220x137x16,0
260140	M-140	147,0	-	240,0	18,0	4.044,45	0,25	240x147x18,0
260150	M-150	158,0	-	250,0	18,0	4.218,07	0,24	250x158x18,0