

Arruela lisa de ferro (comercial) QX - 994

Tabela 94

Arruela Lisa

Qx - 994

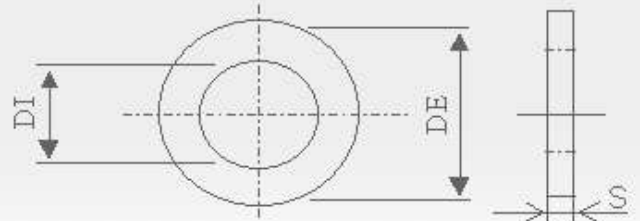

Qualinox

Código 54	Diam. Nominal	Diam. Int.		Diam. Ext.		Espessura E	PESO MIL.	QUANT. MIL.	DIMENSÕES
		di	de	di	de				
940018	1/8	3,3	10,3	1,0	1,0	0,55	1.583	10,3x3,3x1,0	
940532	5/32	4,3	13,2	0,8	0,78	1.286	1.286	13,2x4,3x0,8	
941532	5/32	4,3	13,2	1,2	1,17	857	857	13,2x4,3x1,2	
940316	3/16	5,3	16,0	1,2	1,71	586	586	16x5,3x1,2	
940014	1/4	7,3	19,0	1,2	2,31	434	434	19x7,3x1,2	
940516	5/16	8,8	22,2	1,2	3,11	321	321	22,2x8,8x1,2	
941516	5/16	8,8	22,2	1,6	4,15	241	241	22,2x8,8x1,6	
940038	3/8	10,3	25,4	1,2	4,04	248	248	25,4x10,3x1,2	
941038	3/8	10,3	25,4	1,6	5,38	186	186	25,4x10,3x1,6	
940716	7/16	12,0	30,0	3,0	14,16	71	71	30x12x3,0	
940012	1/2	13,5	32,0	3,0	15,77	63	63	32x13,5x3,0	
940916	9/16	16,0	38,0	3,0	22,25	45	45	38x16x3,0	
940058	5/8	17,0	38,0	3,0	21,63	46	46	38x17x3,0	
940034	3/4	21,0	44,0	3,0	26,00	36	36	44x21x3,0	
940078	7/8	23,0	49,0	3,0	33,74	30	30	49x23x3,0	
940100	1"	27,0	53,0	3,0	38,95	26	26	53x27x3,0	
940118	1" 1/8	31,0	60,0	3,0	45,43	20	20	60x31x3,0	
940114	1" 1/4	35,0	64,0	3,0	53,77	19	19	64x35x3,0	
941516	1" 5/16	35,0	69,0	3,0	66,23	15	15	69x35x3,0	
940138	1" 3/8	36,5	70,0	3,0	66,82	15	15	70x36,5x3,0	
940112	1" 1/2	40,0	78,0	3,0	86,92	12	12	78x40x3,0	
940158	1" 5/8	43,0	83,0	3,0	94,35	11	11	83x43x3,0	
940134	1" 3/4	46,0	86,0	3,0	98,89	10	10	86x46x3,0	
940178	1" 7/8	49,5	93,0	3,0	116,10	8,61	8,61	93x49,5x3,0	
940200	2"	52,5	93,0	3,0	110,37	9,06	9,06	93x52,5x3,0	